

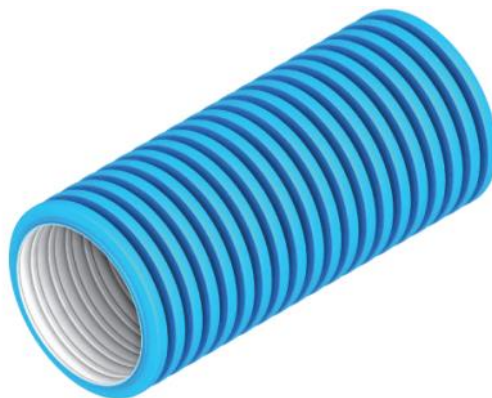

The professional ventilation system that uses manifold distribution to evenly service each room through crushproof semi-rigid ductwork.





Quiet-vent Radial ducting is a crushproof, semi flexible and zero air loss system of 75mm smooth bore pipes with an antistatic and antibacterial lining individually connecting each room through a manifold.

This is a high quality type of ducting with many advantages over older systems providing a quieter and more efficient ventilation system.

Quiet-vent is Suitable to be installed by any competent DIY or tradesperson

- Zero Air Leakage
- Low air resistance
- Quieter with no crosstalk between rooms
- No Sealants required
- Hygienic smooth inner surface
- Reduced installation time
- Easy to install
- Easy to clean
- Supplied in 50M coils
- Crushproof to 16 Kn/m
- SAP Appendix Q recognised
- Up to 85% less connections than conventional rigid ductwork
- Recommend to be installed below your loft insulation improving heat retention compared to older systems
- Suitable for DIY installation

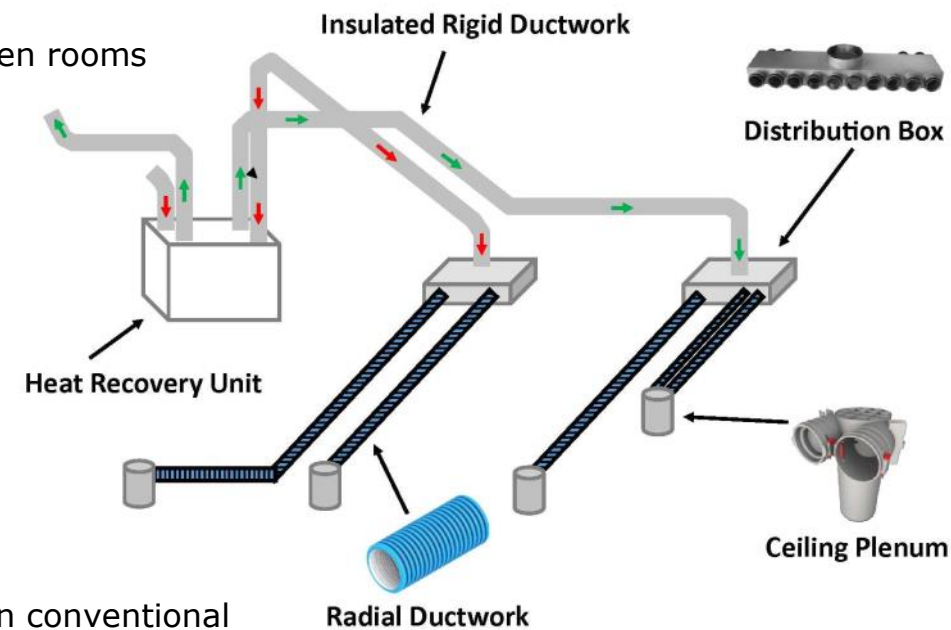

**FREE**  
Design service &  
Technical support

## Radial Pipe



Crushproof pipe with Smooth anti-static and antibacterial inner surface with Corrugated outside surface

**QV75P** - 75mm outer diameter Supplied in 50 Meter coils

15 kN/m<sup>2</sup> crushability and suitable for installation below loft insulation

Temperatures range -5 to +60 degree

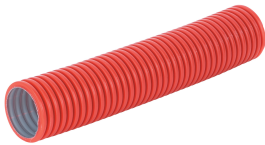

## Manifold – Distribution box

Used for both supply and extract air on floors and ceilings with integrated sealing rings, Available in various types and dimensions to suit any type of installation

**QV16080MH** - 8 point with 8 spigot on bottom with 160mm port on top of box

← Dimensions L/D/H 685 x 185 x 175 - Complete with 4 sealing caps



**QV12560MC** - 6 point with 6 spigot along one side with 125mm port on top of box

← Dimensions L/D/H 520 x 185 x 88 - Complete with 4 sealing caps



**QV16064MC** - 10 point with 6 spigot along one side and 4 spigot on opposite side with 160mm port on top of box

← Dimensions L/D/H 520 x 185 x 88 - Complete with 4 sealing caps



**QV160104MC** - 14 point with 10 spigot along one side and 4 spigot on opposite side with 160mm port on top of box

← Dimensions L/D/H 852 x 185 x 88 - Complete with 4 sealing caps



## Plenum

Used for both supply and extract air on ceilings / wall and accommodates a 125mm air valve

**QVPLEN90** - 90 degree PVC plenum with optional twin connection for increased air flow complete with clips and sealing cap



## Sealing Rings

Used for sealing Radial pipe into Plenums

**QV75SR** - 75mm sealing ring supplied in packs of 10



## Connector

**QVCONS** - Straight connector

**QVCON90** - 90° Connector for very tight bends



## Reducer

Used for reducing the 160mm manifold box to 150mm rigid or flexible ductwork

**RED160150** - 160 Female to 150 male with integrated sealing ring







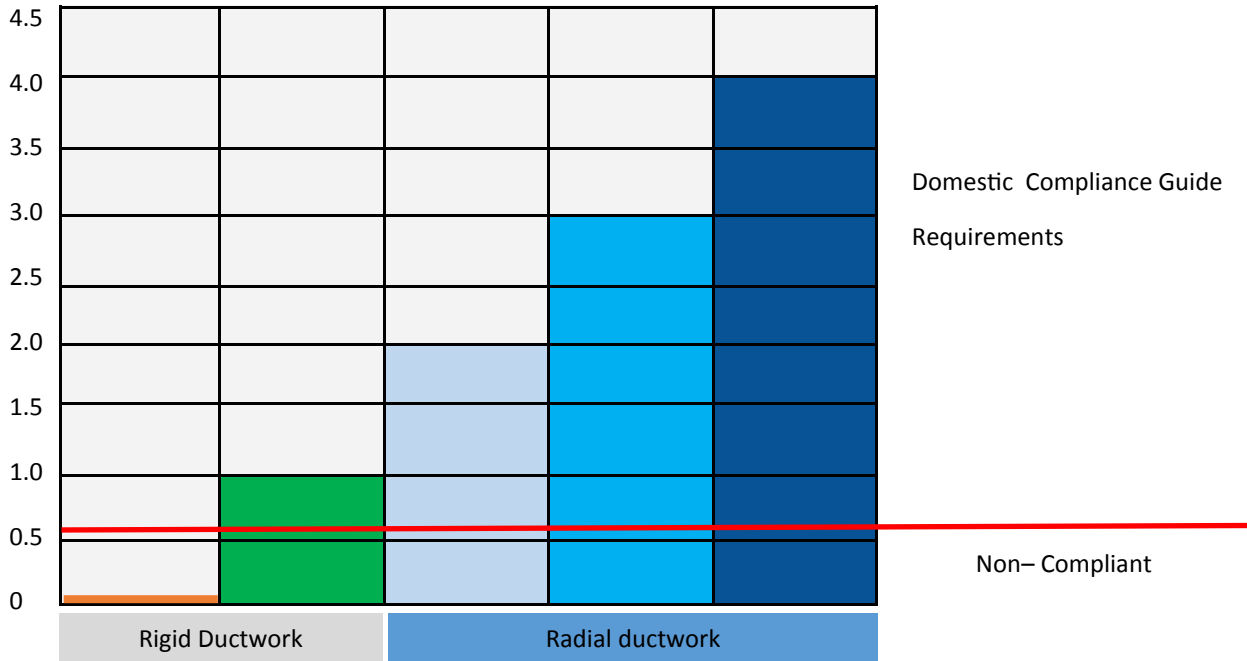

## Insulation of Radial Ductwork

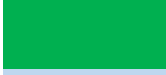
Thermal Resistance (m<sup>2</sup>.K/W)



|   | Thermal Conductivity (W/mK) | Thermal Resistance (m <sup>2</sup> K/W) |
|---|-----------------------------|---|
|  Bubble Wrap | 0.033 x 3.6mm thick         | 0.1                                     |
|  Duct-wrap   | 0.040 x 25mm thick          | 0.7                                     |
|  100mm Wool  | 0.044 x 100mm thick         | 2.0                                     |
|  150mm Wool  | 0.044 x 150mm thick         | 3.4                                     |
|  200mm Wool  | 0.044 x 200mm thick         | 4.5                                     |

As radial ductwork is suitable to walk over we always recommend you insulate over radial pipework in cold unheated loft / Attic voids with mineral wool insulation to retain the best possible heat

Any solid rigid ductwork should be insulated with Duct-wrap above loft insulation to prevent accidental damage caused by standing or setting items on top of it

## Radial Pipe Technical information

|                     |  |
|---------------------|--|
| Length supplied     | 50 x Meter                               |
| External dimensions | 75 mm                                    |
| Internal Dimensions | 63 mm                                    |
| Crushability        | 15 kn/m2                                 |
| Temperature range   | -40 to +90 degree                        |
| internal lining     | Antistatic + Antibacterial               |
| Connection          | Mechanical rubber seal                   |
| Compatibility       | Suitable with all radial ducting systems |

| Air Velocity M/S | Air Volume M3/h | Resistance Pa/mtr |
|------------------|-----------------|-------------------|
| 0.5              | 6               | 0                 |
| 1                | 11              | 0.5               |
| 1.5              | 17              | 0.8               |
| 2                | 22              | 1.5               |
| 2.5              | 28              | 2.2               |
| 2.7              | 30              | 3                 |
| 3                | 33              | 4                 |
| 3.5              | 39              | 5                 |

## Installation Recommendations

- We would recommend that you install twin pipes if air flow requirement exceed 10 L/s or over 15 meter in length
- Quiet-vent ductwork is suitable to be fitted below your loft insulation
- Insulate any ductwork or Manifold/ Distribution boxes with a minimum of 25mm thermal duct wrap that go above insulation in unheated attic spaces
- Position manifolds in a central position as possible to minimise long runs
- Slim-line manifolds are suitable for installation to concrete ceilings and only require a 100mm service void

## Myths and Facts on Radial Ductwork Systems

**Myth :- The pipe can not be cleaned ?**

**Fact:-** Radial ductwork is the only ductwork with an antistatic & antibacterial lining making it near maintenance free and the easiest duct work to clean

**Myth :- It has a higher resistance**

**Fact:-** Radial Ductwork has a lower resistance as there is no joins or fittings connecting the ductwork

**Myth :- It is noisy**

**Fact :-** Radial ductwork stops noise transfer between rooms and eliminates pipe noise that is caused by high volumes of air being pushed down conventional ductwork

**Myth :- you can not insulate radial ductwork**

**Fact :-** Radial ductwork is designed to be installed below you loft insulation that will provide a far superior heat retention than any pre or post insulated ductwork

**Myth:- All ductwork has to be professional installed by trained personal**

**Fact :-** Any competent person can fit radial ductwork as there is very few things that can be fitted wrong , It Is not rocket science !

**Myth :- It will take longer to fit**

**Fact:-** Radial ductwork has up to 85% less fittings and can be up to 50% quicker to install as there is no taping, gluing, or pipe work to join

**Myth :- The pipes will get damaged**

**Fact :-** Radial ductwork is up to four times stronger than conventional pvc rigid ductwork and can be installed in up to 3 meters of concrete

**Myth :- Expensive for large houses**

**Fact :-** The cost of radial ductwork has come down in price and is now only slightly higher than conventional ductwork—When less labour time is taken into consideration it can be less expensive overall

**Myth :- Takes up more space below concrete ceilings**

**Fact :-** With the new slim-line manifolds at only 90mm depth the overall ceiling void can be reduced to 100mm



## Installation information - It is not rocket science

Quiet-vent ductwork is easy to install by any competent person, Simply push the pipe in to the distribution box, cut pipe to length and push into the ceiling plenum.

We also have trained technicians to help and advise you throughout your installation.

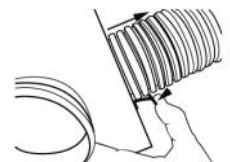
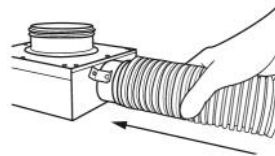

- Install the distribution box in central location to keep ductwork symmetrical and short as possible
- To connect each pipe simply push and "click" to safely lock the radial ducting in place
- It may be required to install a reducer from the distribution box to suite provided ductwork from the heat recovery unit
- It is recommended to install a flexible or solid acoustic silencer between the ventilation unit and the air distribution box in order to further silence the sound of the fan.
- To remove or reposition the radial ductwork simply pull back on the locking tab

### Wall and ceiling Plenum



- The ceiling or wall plenum box have two outlets for the duct.
- To connect each pipe to the plenum insert the rubber washer ring that is fitted in the last groove and pushed into the outlet collar of the plenum
- The pvc models are locked with two locking devices and the metal models are locked by locking tongues

### Duct joiners and fittings



- All duct joins and fitting if required must be sealed with the rubber washer ring that is fitted in the last groove, pushed into the fitting and locked into position



The 21st Century solution to Quality Air in you home

The Use of Radial Duct work is transforming the way Heat Recovery systems are being supplied and fitted



For further information Contact:

**BPC Ventilation**

**+44(0) 2828 275150**

**[www.bpcventilation.com](http://www.bpcventilation.com)**

**[info@bpcventilation.com](mailto:info@bpcventilation.com)**

8 Redlands Road Larne  
Co.Antrim BT40 1 AX